

RETRO KIT A

INSTRUCTIONS FOR:

Retrofit countertop mounted on original single sales terminal

FIRST: REMOVE THE ORIGINAL TOP IN THE CENTER SECTION.

SECOND: MOUNT GREY FILLER IN PLACE ON THE EMPLOYEE SIDE

THIRD: MOUNT DECORATIVE RED CAP OVER THE ORIGINAL ON THE CUSTOMER SIDE.

FORTH: MOUNT THE NEW COUNTERTOP AND DRILL OUT ANY WIRE ACCESS NEEDED FOR CARD SWIPES ETC..

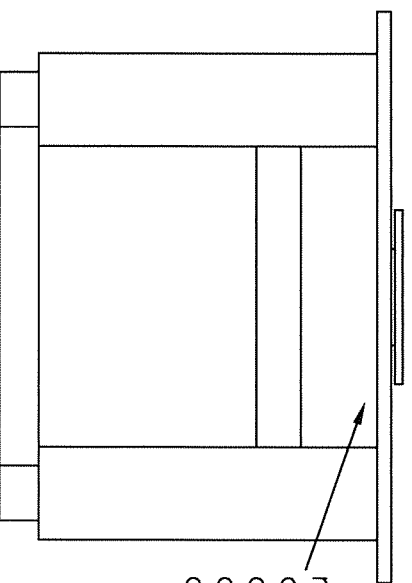

mount decorative red cap in place over the original

220.0 [8 11/16"]

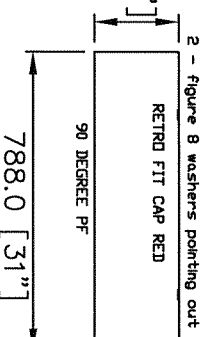

73.0 [2 7/8"]

EMPLOYEE SIDE FILLER 1
SIDE GREY / 1 SIDE CL
pre drill and screw down to center
section using 3" screws

788.0 [31"]

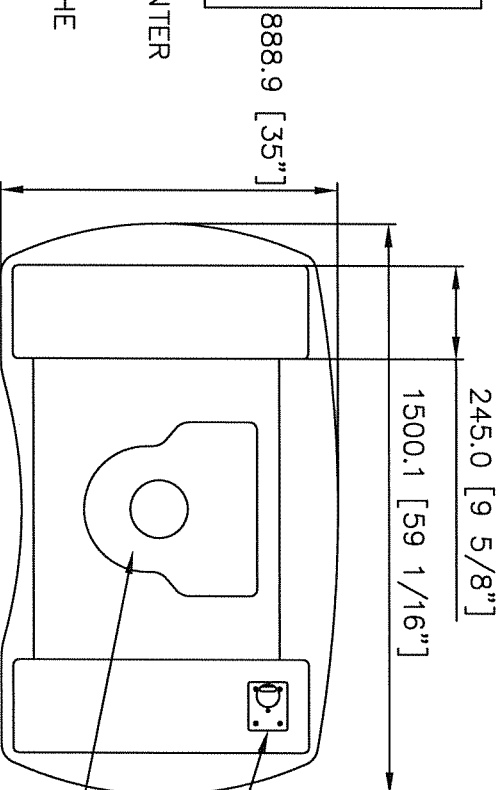

drill card swipe holes in counter top through original top

mount small grey filler in place

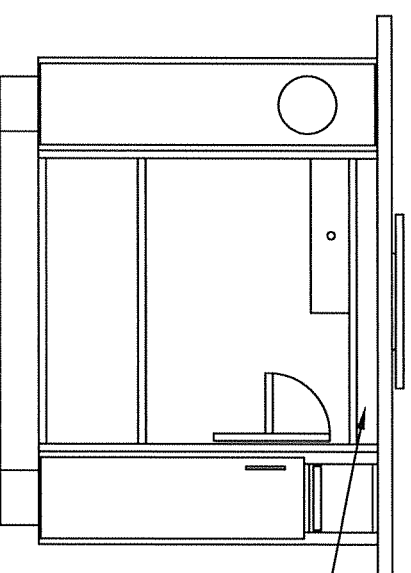

RETRD KIT B

MODIFIED OLDER SINGLE SALES TERMINAL TO BE A DOUBLE SIDE TERMINAL

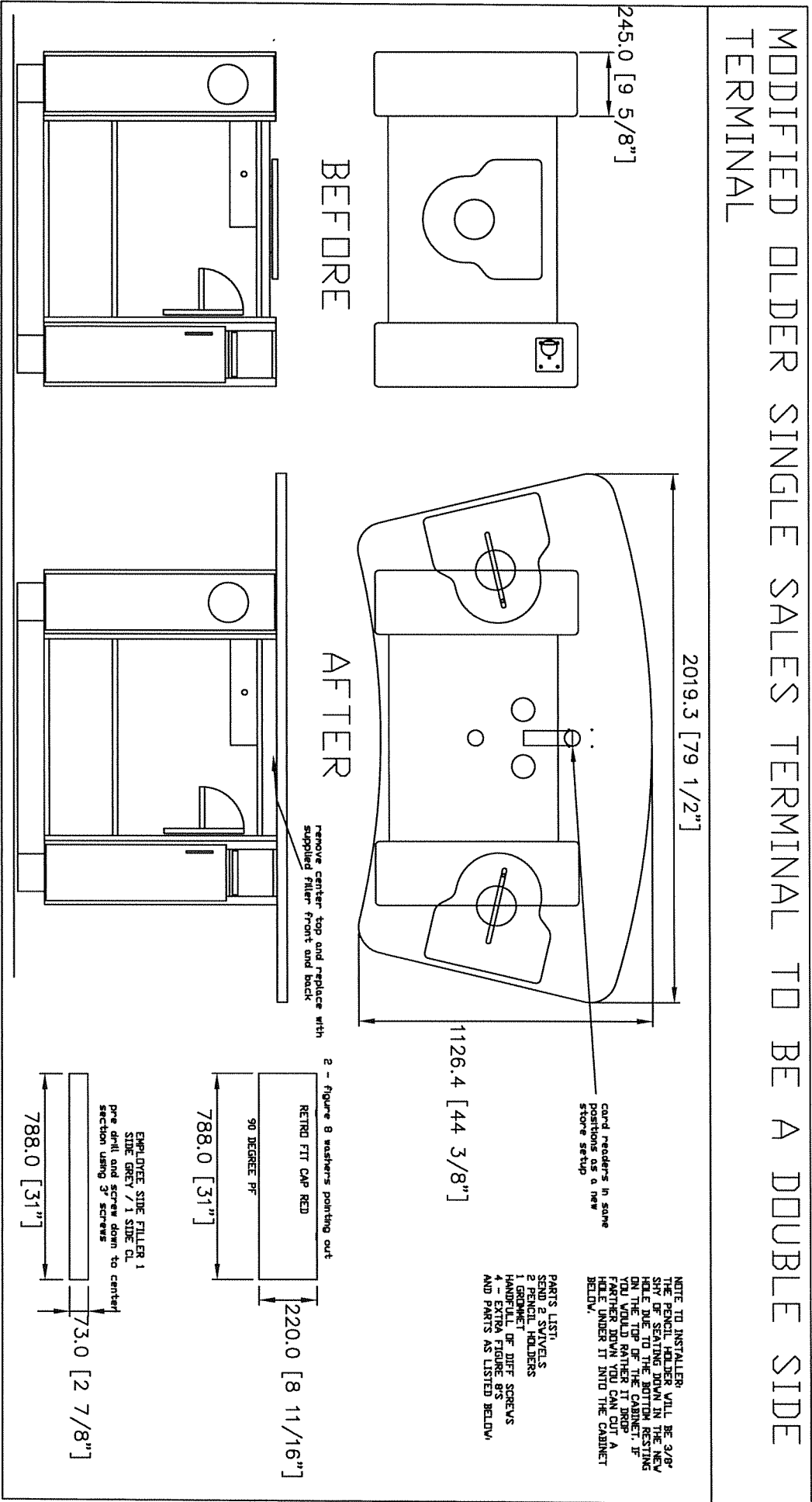

RETRD KIT C

MODIFIED OLDER SINGLE SALES TERMINAL TO BE A DOUBLE SIDE TERMINAL

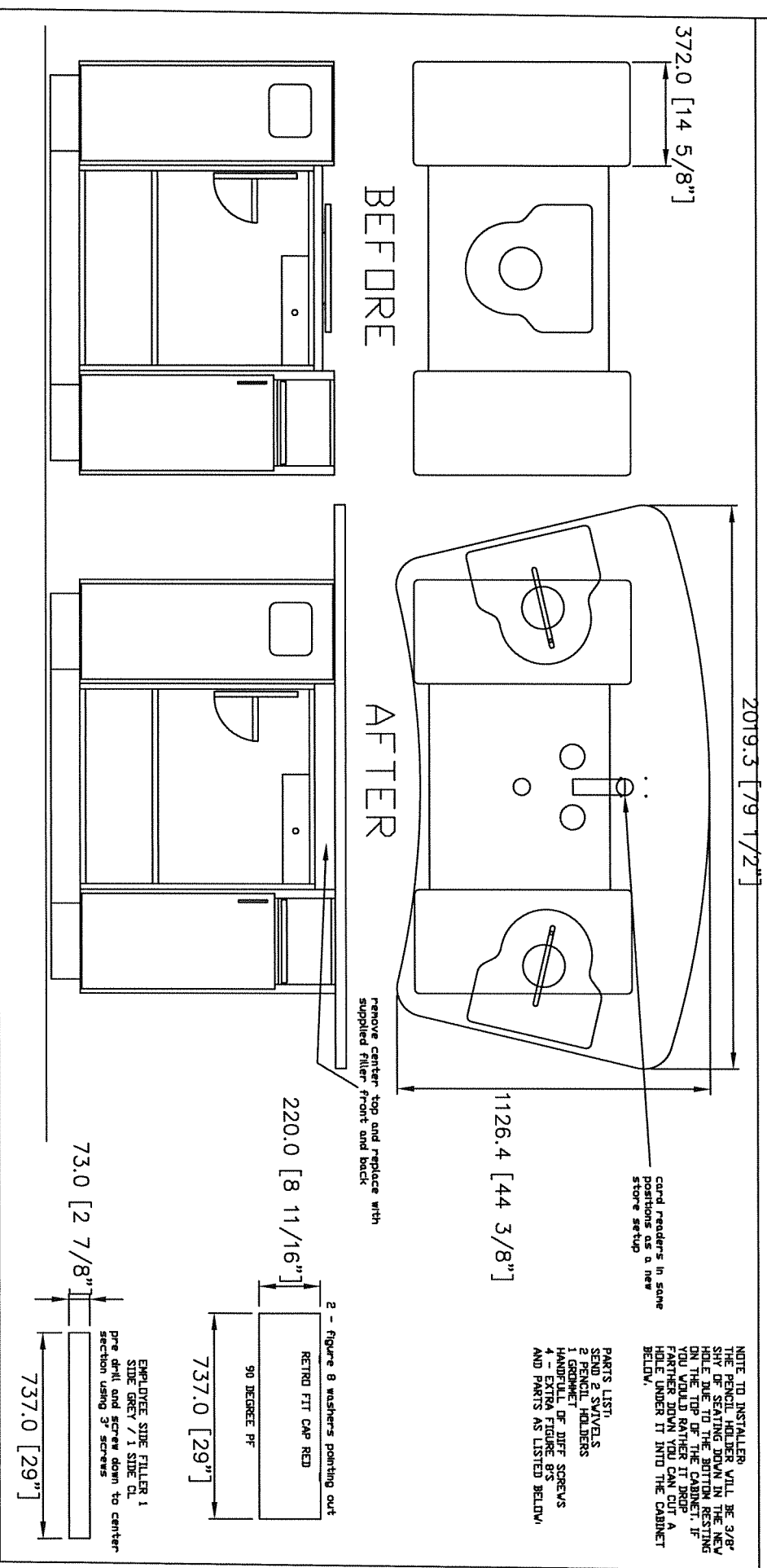

RETRD KIT D

MODIFIED OLDER SINGLE SALES TERMINAL TO BE ADA COMPLIANT
RIGHT HAND SIDE

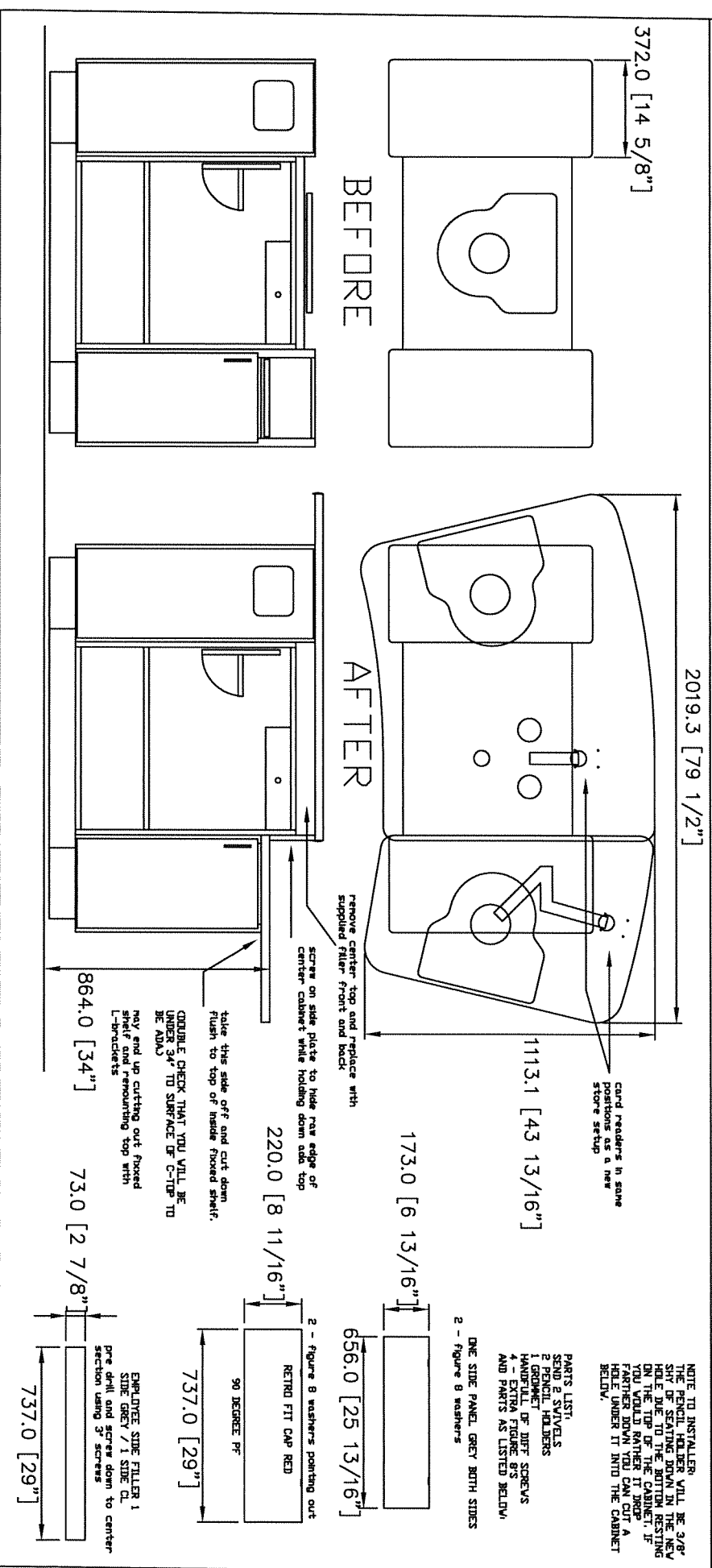

RETRD KIT E

MODIFIED OLDER SINGLE SALES TERMINAL TO BE ADA COMPLIANT RIGHT HAND SIDE

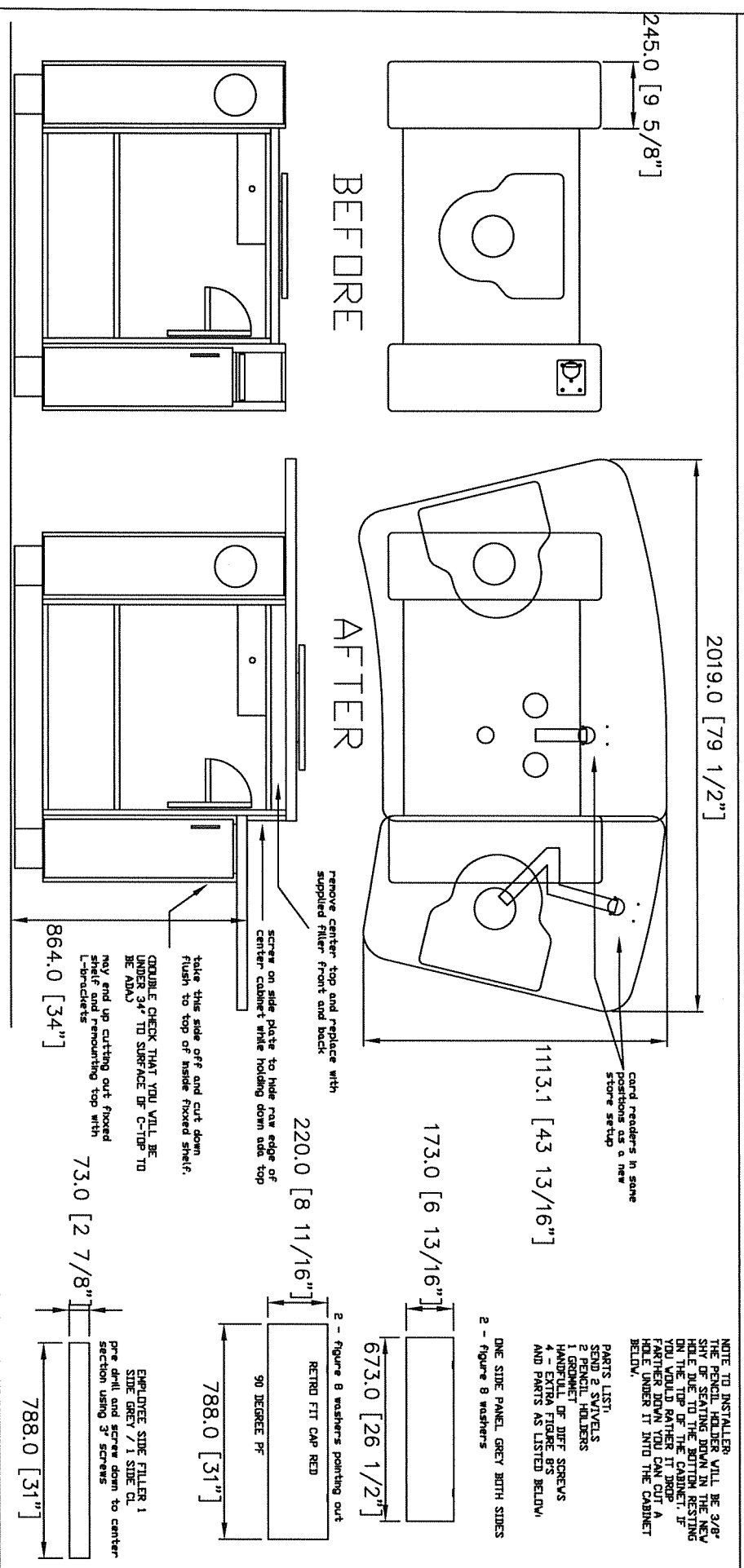

RETRD KIT F

MODIFIED OLDER SINGLE SALES TERMINAL TO BE ADA COMPLIANT LEFT HAND SIDE

NOTE TO INSTALLER:
THE PENCIL HOLDER WILL BE 3/8" SHY OF SEATING DOWN IN THE NEW HOLE DUE TO THE BOTTOM RESTING ON THE NEW TOP OF THE COUNTER. IF YOU WOULD RATHER TO DROP FARTHER DOWN YOU CAN CUT A HOLE UNDER IT INTO THE CABINET BELLY.

PARTS LIST:
SEND 2 SCREWS
2 PENCIL HOLDERS
1 GRINDSET OF DIRT SCREWS
4 SCREW DRIVERS
AND PARTS AS LISTED BELOW

ONE SIDE PANEL GREY BOTH SIDES

2 - Figure 8 washers

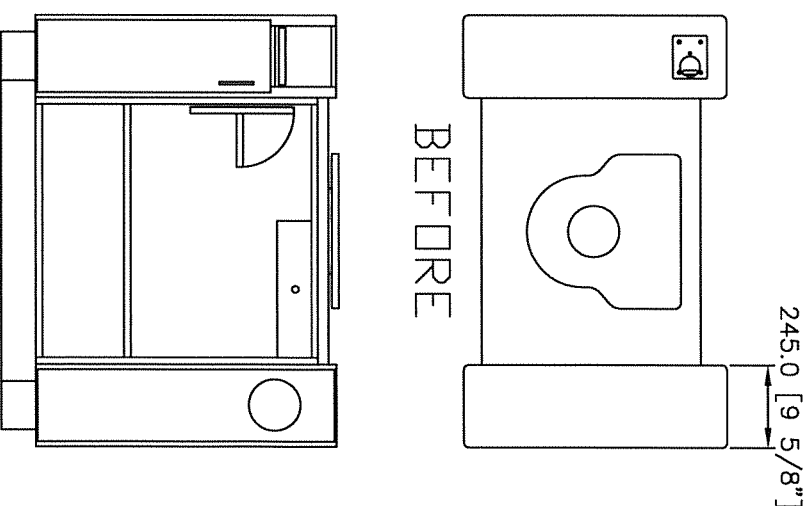
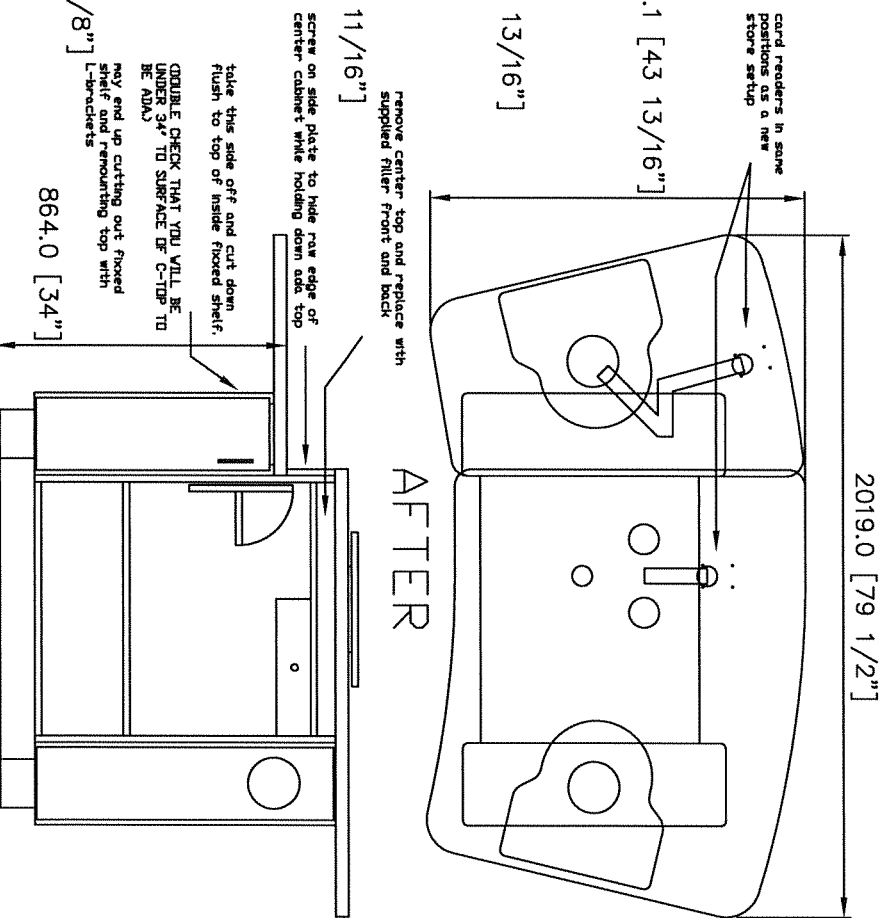
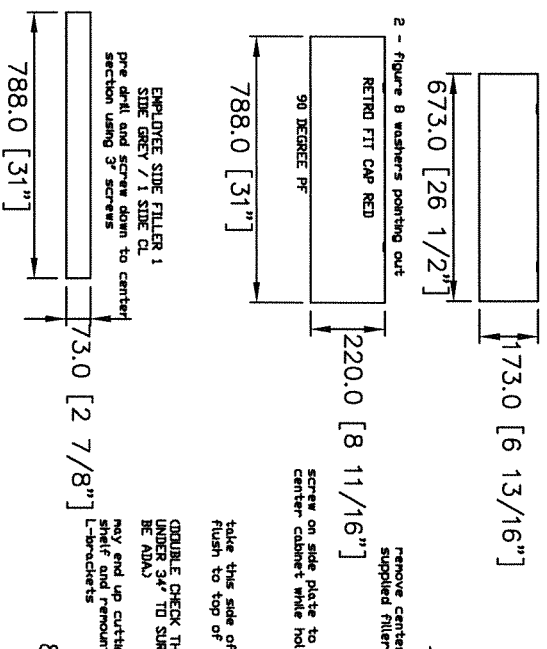

RETRD KIT G

MODIFIED OLDER SINGLE SALES TERMINAL TO BE ADA COMPLIANT LEFT HAND SIDE

2019.3 [79 1/2"]

NOTE TO INSTALLER:
THE PENCIL HOLDER WILL BE 3/8" SHY OF SEATING DOWN IN THE NEW HOLE DUE TO THE BOTTOM RESTING ON THE TOP OF THE CABINET. IF THE PENCIL HOLDER IS NOT SEATED FARTHER DOWN YOU CAN CUT A HOLE UNDER IT INTO THE CABINET BELOW.

PARTS LIST:
2 - PENCIL HOLDERS
1 - PENCIL
1 - SCREW
HANDFULL OF DIFF SCREWS
4 - EXTRA FIGURE 8'S
AND PARTS AS LISTED BELOW.

ONE SIDE PANEL GREY BOTH SIDES
2 - Figure 8 washers

173.0 [6 13/16"]

656.0 [25 13/16"]

2 - Figure 8 washers pointing out

RETRD FIT CAP RED

220.0 [8 11/16"]

90 DEGREE PF

737.0 [29"]

EMPLOYEE SIDE FILLER 1
SIDE GREY / 1 SIDE CL
pre drill and screw down to center
section using 3" screws

73.0 [2 7/8"]

737.0 [29"]

card readers in same
positions as a new
store setup

1113.1 [43 13/16"]

remove center top and replace with
supplied filler front and back

screw on side plate to hide raw edge of
center cabinet while holding down ada top

take this side off and cut down
flush to top of inside fixed shelf.

DOUBLE CHECK THAT YOU WILL BE
UNDER 34" TO SURFACE OF C-TOP TO
BE ADA)

may end up cutting out fixed
shelf and remounting top with
L-brackets

864.0 [34"]

AFTER

BEFORE

372.0 [14 5/8"]